

SOLENOID VALVES | GEM-SOL® | Special Purpose

High Pressure

GEM-SOL® | HP32 (GEM-HP)

High Pressure 1/4"-1" | 2 Way NC, NO

Technical Data

Function	2 Way NC, NO
Ports size	1/4", 1/2", 3/4", 1" BSP & NPT
Pressure range	See table
Kv (l/min)	See table
Temperature range	Fluid : -10°C to 80°C (no freezing) Ambient : -10°C to 50°C
Materials in contact with media	Main Valve: Brass, Stainless Steel AISI 316 Solenoid Operator: Stainless Steel AISI 300 & 400 series Seals: Polyurethane, FKM*, EPDM*, PTFE * The orifice seal is PTFE
Coil voltage	• Voltage and power consumption - see table • All Baccara coil voltages are ± 10% of nominal
Standard protection class	IP65 with connector * Option : IP68 (please refer to GEM-BP Coil)

- Latch valves are available upon request



Brass | 1/2"

Stainless Steel | 1/2"

Pressure (bar) & Flow NC

Size	Orifice (mm)	Pressure (bar)	Kv(l/min)
1/4"	8	1 to 60	12
1/2"	12		35
3/4"	20		130
1"	25		200

Pressure (bar) & Flow NO

Size	Orifice (mm)	Pressure (bar)	Kv(l/min)
1/4"	8	1 to 30	12
1/2"	12		35
3/4"	20		130
1"	25		200

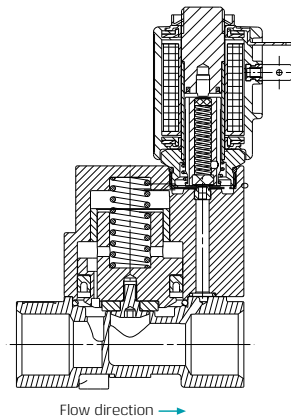

Voltage & Power Consumption

V	AC (W)						DC (W)		
	50 Hz			60 Hz			10	5.5	3.5
6	•			•			•		
12	•			•			•		
24	•			•			•		
48	•			•			•		
110	•			•			•		
120	•			•			•		
220	•			•			•		
230	•			•			•		
240	•			•			•		

- Available options

GEM-SOL® | HP32 (GEM-HP) | High Pressure 1/4"-1" | 2 Way NC, NO

Dimensions

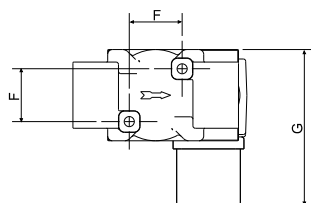

Size	A	B	C	D	E	F	G
1/4"	58	32	10.5	118	91.5	22	58.9
1/2"	69	38	13	130	102.5	22	64.9
3/4"	90	55	17	140	-	-	73.1
1"	100	65	21	151	-	-	78.1

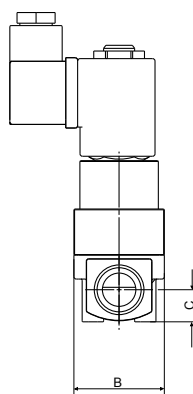
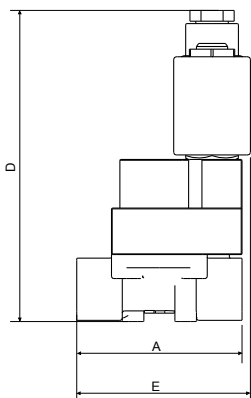

How to Order

* When ordering without coil, please define what current and pressure rating is needed (DC, AC)

GEM-HP	BODY	PORT	FUNCTION	SEALS	VOLTAGE	POWER	CONNECTOR					
Brass	2	1/4" BSP	20	2W NC 1	Polyurethane	P	without coil 0	No coil 0	with 1			
Stainless Steel *	3	1/4" NPT	21	2W NO through base * 2a	FKM ⁽¹⁾	V	6 ⁽²⁾	1	AC8W 50Hz	1	with LED	2
		1/2" BSP *	40		EPDM ⁽¹⁾	E	12	2	AC8W 60Hz	2	flying leads coil *	4
		1/2" NPT *	41		PTFE *	T	24	3	DC10W	3	with 1/2" Hub	5
		3/4" BSP	50				48	4			surge protection with LED *	6
		3/4" NPT	51				110	5			connector with moulded cable	7
		1" BSP *	60				120	6			other	9
		1" NPT *	61				220	7A				
				230	7							
				240	8							
				Latch/other * ⁽³⁾	9							

* **SPECIAL OPTIONS** | Extended lead times, Non-stock items, MOQ may be applicable

Example : GEM-HP-2201P-321

GEM-SOL® HP32 (GEM-HP) High Pressure, Brass, 1/4" BSP, 2W NC, Polyurethane seals, 24VAC 8W 60Hz with connector.

(1) The orifice seal is PTFE

(2) DC only

(3) For specifying Latch type coil, please refer to A3P32 (GEM-A3P) valve - How to Order table

* To order valves manufactured according to your specific requirements, please contact our technical sales department.